



SERVICE BULLETIN 391

426 Industrial Boulevard • Kearneysville WV 25430-2776 • USA
 Telephone: +1 304 728 7056 • technicalinquiry@royalvendors.com
 Toll-free in North America: 1 800 931 9214 • Fax: +1 304 725 4016
 Canada: +1 905 738 5777 • Mexico: +52 55 5203 6887
 Europe: +49 2158 95 1000 • Australia: +61 2 9890 5433

Page: 1 of 1

Date: 12 Aug 2014

Revision: 00

SUBJECT: Clear Board Cover Installation on GIII Venders

MODELS: GIII, GIII Plus

Number of
People
Required



KIT NUMBER

KIT DESCRIPTION

381577

Control Board Cover Kit GIII



The following areas of this vender contain voltage which can cause serious injury or even death: the main power cord, supplying 115-230 VAC to the evaporator, EMI filter, refrigeration system, monitor, and computer; the power line from the EMI filter to the ballast and transformer; and the ballast, which can produce upwards of 600 volts. Remove all power from the vender before working in any of these areas.

TOOLS REQUIRED: Phillips screwdriver

ESTIMATED INSTALLATION TIME: <5 minutes

REASON FOR BULLETIN: A new clear board cover has been designed for use in GIII and GIII Plus venders to replace the black Kydex® cover that was previously used.

INSTALLATION INSTRUCTIONS:

1. Remove power by unplugging the vender's power cord from the AC voltage source (wall outlet).
2. Remove the existing black Kydex cover from the control board housing.
3. Using a Phillips screwdriver, secure the new clear control board cover assembly as shown in the illustrations below. Note that there are four mounting holes in the cover assembly bracket. These holes will match up with at least two holes already existing in the control board housing. Use these two holes to secure the control board cover, as shown.
 - **Note:** If any ground (earth) wires are secured by a screw in the top of the control board housing, remove them before installing the control board cover. After installing the cover assembly, secure these ground (earth) wires with one of the screws used to secure the assembly.
 - **CAUTION:** When installing the screws to secure the cover assembly, take great care to avoid the heat sinks and other components of the control board. The control board can be easily damaged by striking these components.
4. Restore power by plugging the vender's power cord into the AC voltage source (wall outlet).

Control board housing before cover installation

The two holes pointed out in this photo can be used for mounting the control board cover assembly. The holes used in some housings may be in other positions.



Control board cover assembly installed

In this photo, the assembly is installed and secured with two screws.

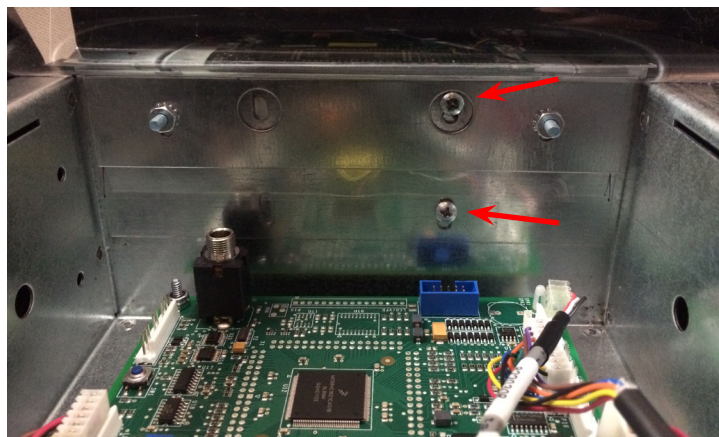

In an effort to provide our customers with the latest information on our equipment, Royal Vendors sends service bulletins to customers using the original ship-to address or e-mail addresses, if supplied by our customers. We also post all service bulletins on our website at www.royalvendors.com. If for any reason a vender is moved to another location or is sold to another customer other than to whom Royal Vendors originally sent the machine, it is the responsibility of the original purchaser of the vender to notify the appropriate personnel of the service bulletin.

**ANY QUESTIONS? CONTACT ROYAL VENDORS' CUSTOMER SERVICE DEPARTMENT
 IN NORTH AMERICA, CALL TOLL FREE 1 800 931 9214**