



SERVICE BULLETIN # 00187

201 INDUSTRIAL BOULEVARD • KEARNEYSVILLE, WV 25430

Phone: (304) 728-7056 • Fax: (304) 725-6579 • Toll Free: (800) 931-9214

PAGE: 1 of 2

DATE: 6-20-02

REVISION: 02

SUBJECT: No Vend/ Free Vend Switch Kit

MODELS: Merlin IV

| KIT NUMBER | KIT DESCRIPTION |
|------------|-----------------------------------|
| 256117 | No Vend/Free Vend Switch Kit Assy |



The following areas of this vender contain voltage, which can cause serious injury or even death. The main power cord, supplying 110 VAC to the evaporator, EMI filter, and refrigeration system. The power line from the EMI filter to the ballast and transformer. The ballast can produce upwards of 600 volts. Remove power from vender before working in any of these areas.

Instructions:

NO VEND

1. Unplug vender.
2. Disconnect Option Harness (which is currently part of the Main Door Harness) then plug the female end of the Interface Harness in its place (position P9 Coinco board fig 1.1 and position J9 Versatile board).
3. Plug the 5 pin male end of the Interface Harness into existing Option Harness.
4. Connect the male housing 2 red wires and 1 grey wire) of the Interface Harness to the female housing of the Key Switch Harness.
5. Route harnessing through the vender's door and locate an approximate position to mount the key switch lock assembly.
6. Drill 3/4" dia. hole and mount the key switch lock in the desired position.
7. Plug the two connections to the key switch lock terminals.
8. Access the controllers "StCL" mode and program the desired individual selections or "ALL" to "1" so that they will work with the installed key switch lock. If any setting in "StCL" is set to "0" that setting will ignore any key switch action.

NOTE: For detailed instructions of how to program the "StCL" mode, please refer to the operation and service manual for your type of vender.

10. While in a sales mode upon key switch activation:
 - ◆ If all selections in the "StCL" mode are set to "1" the display will continually flash "not sold"
 - ◆ If only a few of the selections are set to "1" in "StCL", the display will show the correct greeting and upon attempting the locked out selections the display will flash "not sold".

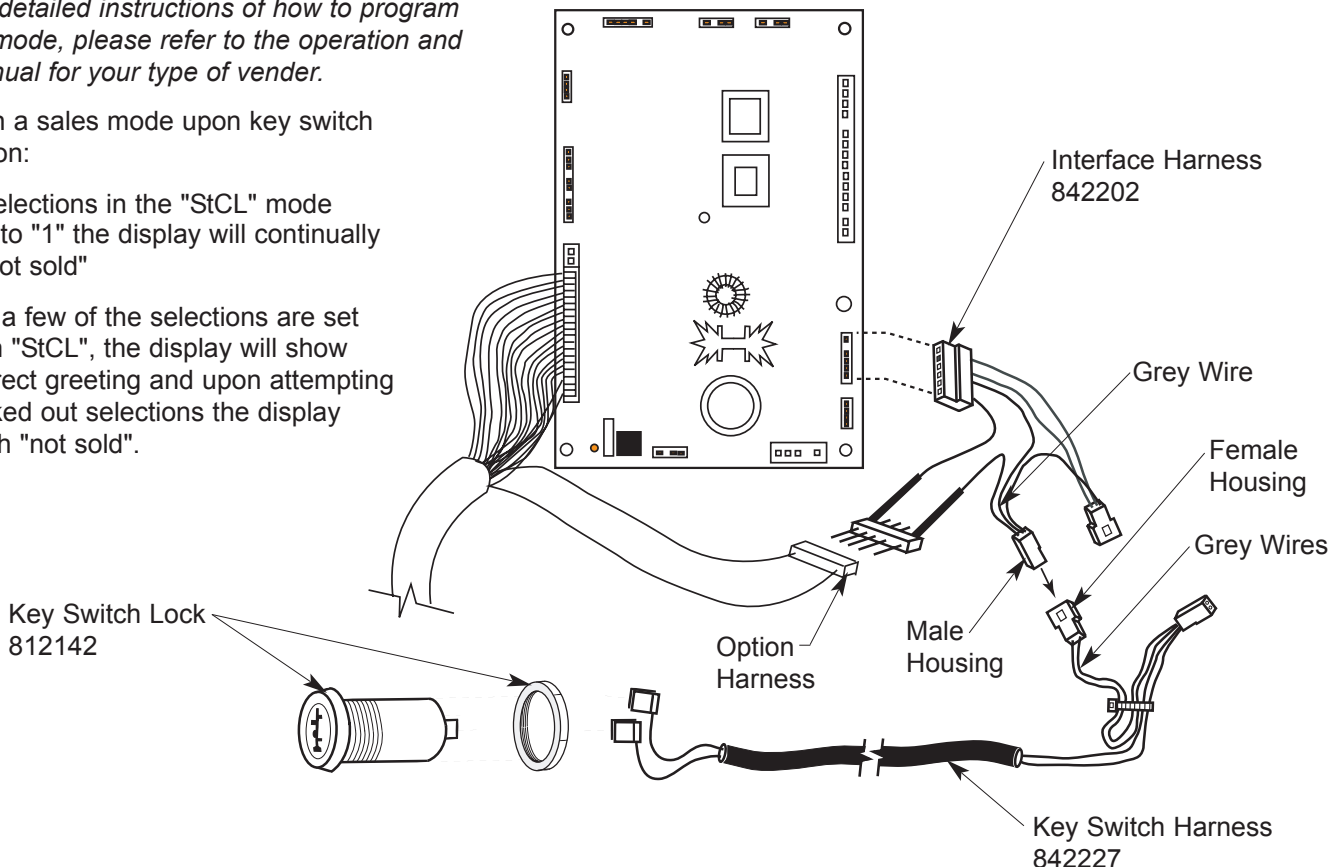

**ANY QUESTIONS??? CONTACT ROYAL VENDORS' CUSTOMER SERVICE DEPARTMENT
CALL TOLL FREE (800) 931-9214**



SERVICE BULLETIN # 00187

201 INDUSTRIAL BOULEVARD • KEARNEYSVILLE, WV 25430

Phone: (304) 728-7056 • Fax: (304) 725-6579 • Toll Free: (800) 931-9214

PAGE: 2 of 2

DATE: 6-20-02

REVISION: 02

SUBJECT: No Vend/ Free Vend Switch Kit

MODELS: Merlin IV

FREE VEND

1. Unplug vender.
2. Disconnect Option Harness (Which is currently part of the Main Door Harness) then plug the female end of the Interface Harness in its place (position P9 Coinco board fig 1.1 and position J9 Versatile board).
3. Plug the 5 pin male end of the Interface Harness into existing Option Harness.
4. Connect the female housing (2 red wires and 1 white wire) of the Interface Harness to the male housing of the Key Switch Harness.
5. Route harnessing through the vender's door and locate an approximate position to mount the key switch lock assembly.
6. Drill 3/4" dia. hole and mount the key switch lock in the desired position.
7. Plug the two connections to the key switch lock terminals.
8. While in a sales mode upon key switch activation the display will show "FrEE" after the greeting.

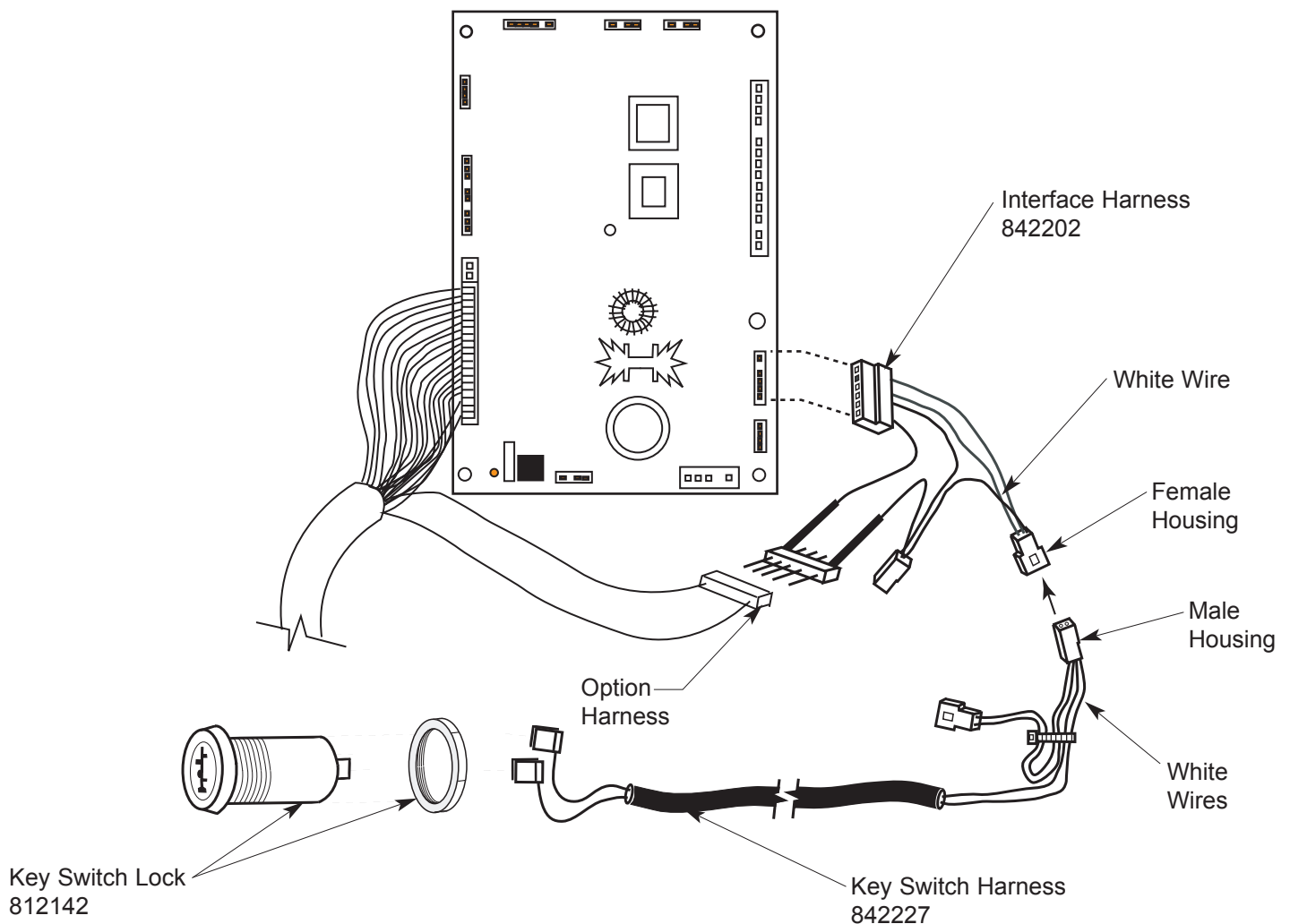

ANY QUESTIONS??? CONTACT ROYAL VENDORS' CUSTOMER SERVICE DEPARTMENT
CALL TOLL FREE (800) 931-9214